

PROCESSING PHASE: **Illumination**

- 1. Tap Begin Treatment button, choose which drawer(s) to load and log in**

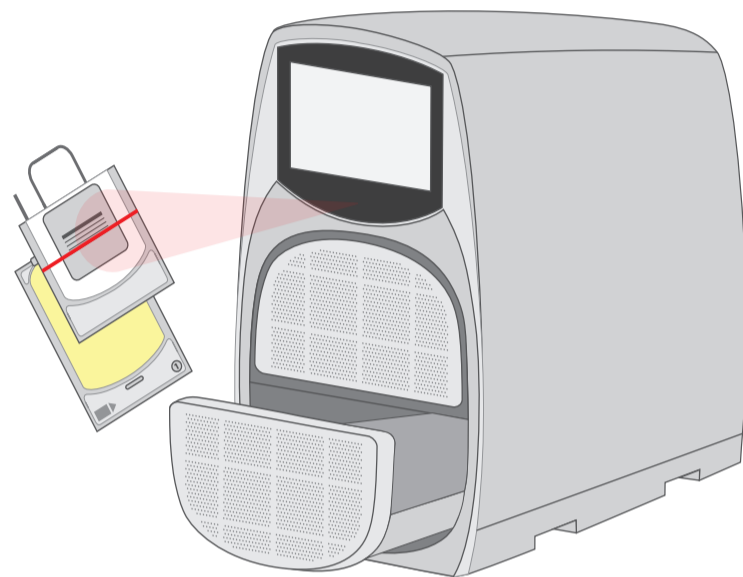

- 2. Load processing set(s) and scan bar codes**



Correct:

- Tray is clean
- Illumination container has minimal air and labels, if present, are located where they will not block exposure to UV light
- The illumination container is placed completely within the large area of the tray, including the tubing stub that was sealed off prior to illumination.
- Other parts of the processing set are placed in the smaller area of the tray in the deepest part.

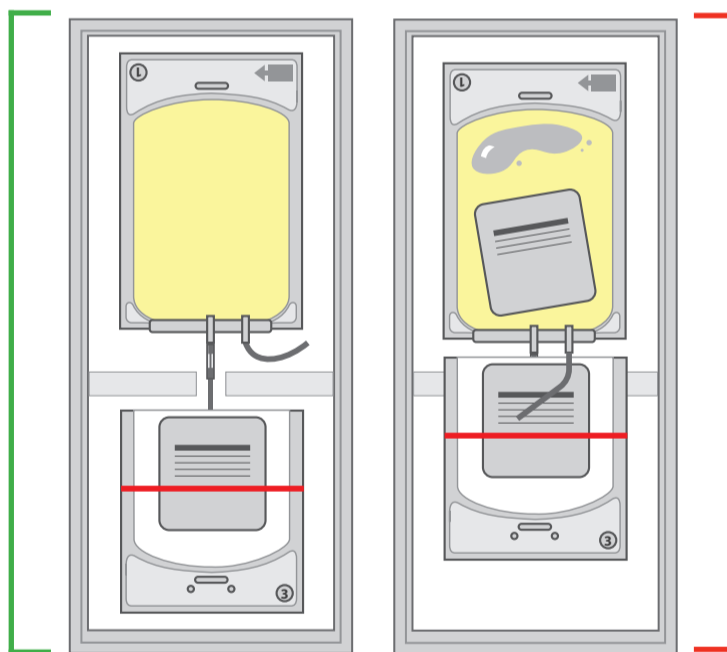

Incorrect:

- Tray is not clean.
- Illumination container has significant amount of air and a label covers the fluid containing region impeding exposure to UV light
- The tubing stub that is outside the large area of the tray and may not receive UV light.
- Other parts of the processing set are too far forward and are not placed in the deepest part of the tray.

- 3. Close drawer and begin illumination cycle**

- 4. When illumination cycle is complete, verify container status and unload processing set(s)**